

**Ashtree Avenue
Colliers Wood Borders, CR4 3DR**

Offers Over £300,000 Leasehold - Share of Freehold



A superb example of a conversion garden flat that is beautifully presented throughout creating a contemporary feel. The property has original stripped floorboards and benefits from its own front door and private garden, with ample under stair storage. This lovely property is located on a highly sought after road close to shopping and transport facilities and is ideal for a first time buyer.

Ashtree Avenue, CR4

Approximate Gross Internal Area = 43.2 sq m / 465 sq ft

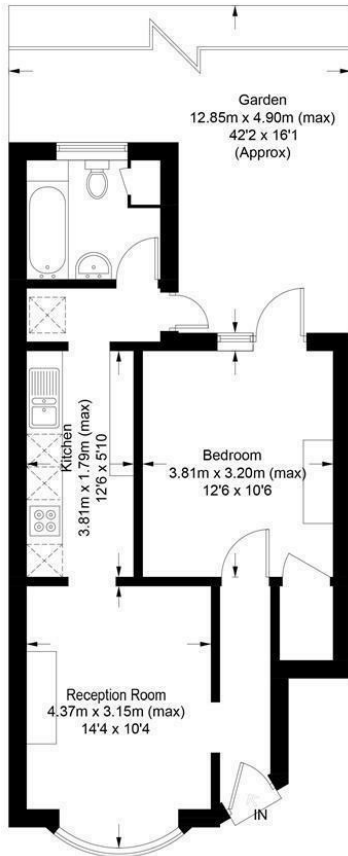

Ground Floor

This floor plan is for representation purposes only and is not drawn to scale.
The Gross Internal Area includes outbuildings shown on the plan.
 Whilst every attempt has been made to ensure the accuracy of the plan measurements of doors, windows and rooms are approximate only and should be checked before making any decisions reliant upon them.
 Copyright Bespokeplans.co.uk (ID680644)

- Conversion Maisonette
- One Double Bedroom
- Private Rear Garden
- Close To Transport Links
- Amenities Nearby
- Ideal First Time Purchase

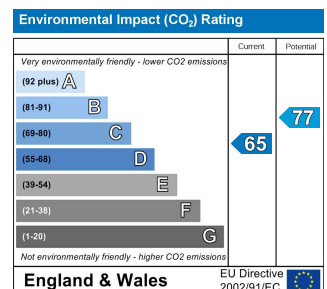
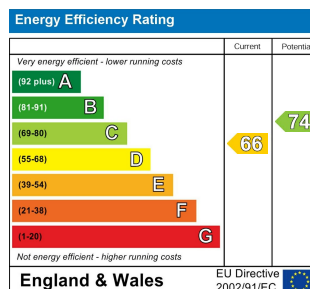

For Free Mortgage Quote and Best Mortgage Rates, call an Ellisons Mortgage Advisor on 020 8544 0518



Although these particulars are believed to be correct, their accuracy is not guaranteed and they do not form part of any contract.

Celebrating 30 years of successful Sales and Lettings in Merton

